

## Gantry crane | GC2 | 2.000 kg

- Can only be used for the application for which it is designed, namely for moving materials of various kinds, in combination with a hoisting device.
- The gantry crane is supplied with castor wheels, which makes the crane easy to move around in the workspace. The castor wheels are equipped with a brake.
- Beam is available in 3 lengths.
- Beam has an I Profile IPE 240.
- Easy to combine with beams clamps or trolleys to mount a hoist on the gantry crane.
- Fit for various workplace applications, such as general factories, warehouses, and workshops.

Type	GC2
Brand	Mitari
Temperature range	-10 °C to + 40 °C
Norm hoist	NEN-EN 12100-1/2
HS code	84314920

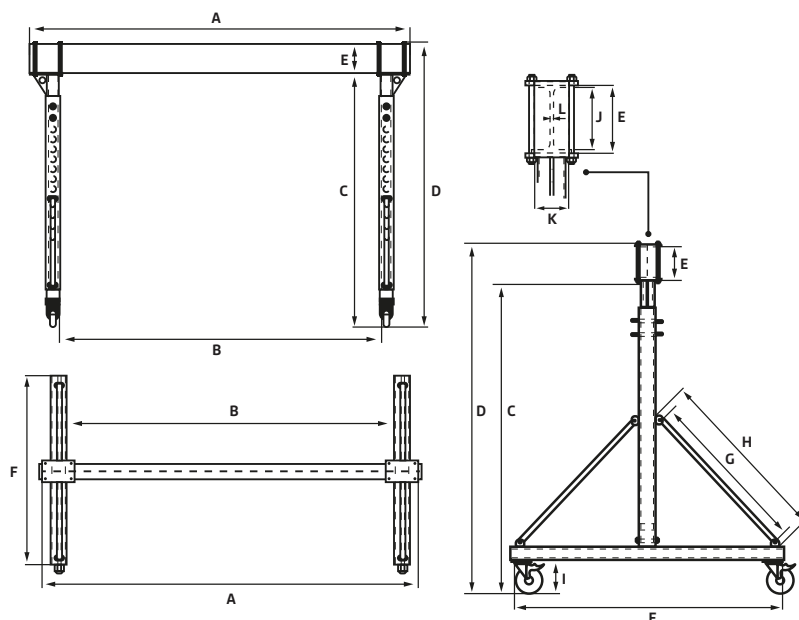

Type	A mm	B mm	C mm	D mm	E mm	F mm	G mm	H mm	I mm	J mm	K mm	L mm
GC.35	3500	3000	min. 2375 - max. 3575	2653	240	2000	1000	1030	252	220.4	120	6.2
GC.45	4500	4000	min. 2375 - max. 3575	2653	240	2000	1000	1030	252	220.4	120	6.2
GC.55	5500	5000	min. 2375 - max. 3575	2653	240	2000	1000	1030	252	220.4	120	6.2